

STUB ENDS

TYPE A STUB ENDS - MACHINE FINISH 14VB

TUBE O.D.	A	B	C	316L PART NUMBER
1/2"	2.00	1.50	0.13	W614VB-.50
3/4"	2.00	1.50	0.13	W614VB-.75
1"	1.62	2.00	0.13	W614VB-1
1-1/2"	1.75	2.87	0.13	W614VB-15
2"	1.50	3.62	0.13	W614VB-2
2-1/2"	2.00	4.12	0.13	W614VB-25
3"	2.25	5.00	0.17	W614VB-3
4"	2.62	6.19	0.17	W614VB-4
6"	3.00	8.50	0.22	W614VB-6
8"	3.00	10.62	0.23	W614VB-8
10"	3.50	12.75	0.28	W614VB-10
12"	3.00	15.00	0.28	W614VB-12

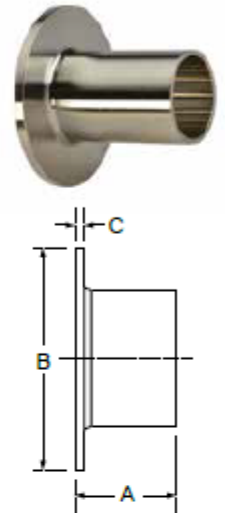

- Compatible with 38SL Tube Flanges
- Machine Finished to 32RA

SLIP-ON TUBE FLANGES - MACHINE FINISH 38SL

TUBE O.D.	A	BOLT HOLE (B)	BOLT CIRCLE (C)	D	ID BORE (E)	# BOLT HOLES	304 PART NUMBER	316L PART NUMBER
1/2"	3.50	0.62	2.75	0.50	0.56	4	--	W638SL-.50
3/4"	3.87	0.62	2.75	0.50	0.81	4	--	W638SL-.75
1"	4.25	0.62	3.12	0.50	1.06	4	W438SL-1	W638SL-1
1-1/2"	5.00	0.62	3.87	0.50	1.56	4	W438SL-15	W638SL-15
2"	6.00	0.75	4.75	0.50	2.06	4	W438SL-2	W638SL-2
2-1/2"	7.00	0.75	5.50	0.50	2.56	4	W438SL-25	W638SL-25
3"	7.50	0.75	6.00	0.50	3.06	4	W438SL-3	W638SL-3
4"	9.00	0.75	7.50	0.50	4.06	8	W438SL-4	W638SL-4
5"	10.00	0.87	8.50	0.50	5.06	8	W438SL-5	W638SL-5
6"	11.00	0.87	9.50	0.50	6.06	8	W438SL-6	W638SL-6
8"	13.50	0.87	11.75	0.50	8.06	8	W438SL-8	W638SL-8
10"	16.00	0.98	14.27	0.50	10.06	12	W438SL-10	W638SL-10
12"	19.00	0.98	17.00	0.50	12.06	12	W438SL-12	W638SL-12

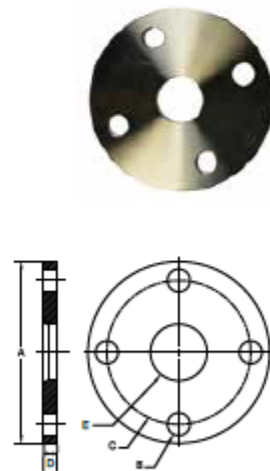

- 150# Bolt Pattern
- ASTM A182 forged