

# MISCELLANEOUS CLAMP CONFIGURATIONS

## CLAMP LATERALS 28AMP

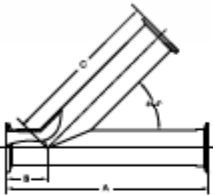

TUBE O.D.	A	B	C	316L PART NUMBER
1"	7.00	1.50	5.50	W628AMP-1
1-1/2"	8.37	1.69	6.69	W628AMP-15
2"	9.75	2.12	7.62	W628AMP-2
2-1/2"	11.00	2.00	9.00	W628AMP-25
3"	11.75	2.37	9.37	W628AMP-3
4"	14.06	2.64	11.37	W628AMP-4
6"	19.75	4.38	15.38	W628AMP-6

## CLAMP TRUE WYES 28BMP

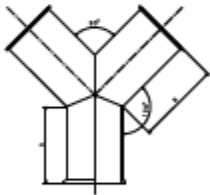

TUBE O.D.	A	B	316L PART NUMBER
1"	2.50	2.94	W628BMP-1
1-1/2"	2.50	2.94	W628BMP-15
2"	3.12	3.75	W628BMP-2
2-1/2"	3.87	4.62	W628BMP-25
3"	4.50	5.37	W628BMP-3
4"	6.00	6.00	W628BMP-4
6"	8.69	9.50	W628BMP-6

## CLAMP CROSSES 9MP

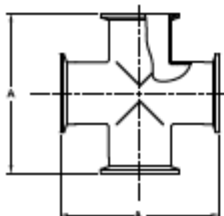

TUBE O.D.	A	316L PART NUMBER
1/2"	4.50	W69MP-.50
3/4"	4.75	W69MP-.75
1"	4.75	W69MP-1
1-1/2"	5.50	W69MP-15
2"	7.00	W69MP-2
2-1/2"	7.00	W69MP-25
3"	7.50	W69MP-3
4"	9.00	W69MP-4
6"	12.75	W69MP-6