

CLAMP FERRULES

REDUCING ROLL-ON FERRULES 31RMP

CLAMP END	TUBE O.D.	A	B	C	316L PART NUMBER
1-1/2"	1"	0.75	1.01	1.16	W631RMP-15X1
2"	1"	0.75	1.01	1.16	W631RMP-2X1
2"	1-1/2"	1.12	1.51	1.68	W631RMP-2X15
2-1/2"	1-1/2"	1.12	1.51	1.68	W631RMP-25X15
2-1/2"	2"	1.12	2.01	2.19	W631RMP-25X2
3"	1-1/2"	1.31	1.51	1.68	W631RMP-3X15
3"	2"	1.31	2.01	2.19	W631RMP-3X2
4"	2-1/2"	1.37	2.51	2.69	W631RMP-4X25
4"	3"	1.37	3.01	3.22	W631RMP-4X3

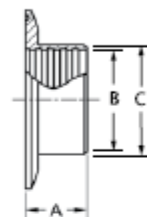

TANK FERRULES (LIGHT DUTY) 14WLMP



TUBE O.D.	A	B	C	304 PART NUMBER	316L PART NUMBER
1/2"	3.000	0.37	0.50	--	W614WLMP-.50
3/4"	3.000	0.62	0.75	--	W614WLMP-.75
1"	3.000	0.87	1.00	W414WLMP-1	W614WLMP-1
1-1/2"	3.000	1.37	1.50	W414WLMP-15	W614WLMP-15
2"	3.000	1.87	2.00	W414WLMP-2	W614WLMP-2
2-1/2"	3.000	2.37	2.50	W414WLMP-25	W614WLMP-25
3"	4.000	2.87	3.00	W414WLMP-3	W614WLMP-3
4"	4.000	3.83	4.00	W414WLMP-4	W614WLMP-4
6"	6.000	5.78	6.00	W414WLMP-6	W614WLMP-6
8"	6.000	7.78	8.00	--	W614WLMP-8
10"	6.000	9.78	10.00	--	W614WLMP-10
12"	6.000	11.78	12.00	--	W614WLMP-12

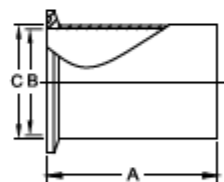

TANK FERRULES (HEAVY DUTY) 14MPW



TUBE O.D.	A	B	C	304 PART NUMBER	316L PART NUMBER
1/2"	1.62	0.32	0.50	--	W614MPW-.50
3/4"	1.62	0.57	0.75	--	W614MPW-.75
1"	1.62	0.87	1.16	W414MPW-1	W614MPW-1
1-1/2"	1.62	1.37	1.68	W414MPW-15	W614MPW-15
2"	1.75	1.87	2.19	W414MPW-2	W614MPW-2
2-1/2"	1.75	2.37	2.71	W414MPW-25	W614MPW-25
3"	1.81	2.87	3.22	W414MPW-3	W614MPW-3
4"	2.12	3.83	4.26	W414MPW-4	W614MPW-4
6"	2.50	5.76	6.19	W414MPW-6	W614MPW-6
8"	2.50	7.76	8.19	--	W614MPW-8

