

# CLAMP TEES

## CLAMP TEES 7MP

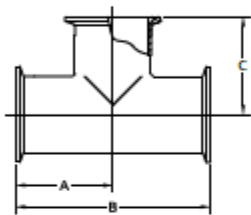

TUBE O.D.	A	B	C	304 PART NUMBER	316L PART NUMBER
1/2"	2.37	4.75	2.37	--	W67MP-.50
3/4"	2.50	5.00	2.50	--	W67MP-.75
1"	2.37	4.75	2.37	W47MP-1	W67MP-1
1-1/2"	2.75	5.50	2.75	W47MP-15	W67MP-15
2"	3.50	7.00	3.50	W47MP-2	W67MP-2
2-1/2"	3.50	7.00	3.50	W47MP-25	W67MP-25
3"	3.75	7.50	3.75	W47MP-3	W67MP-3
4"	4.50	9.00	4.50	W47MP-4	W67MP-4
6"	6.50	13.00	6.50	W47MP-6	W67MP-6
8"	7.88	15.75	7.88	--	W67MP-8
10"	9.38	18.75	9.38	--	W67MP-10
12"	10.88	21.75	10.88	--	W67MP-12

## SHORT OUTLET CLAMP TEES 7MPS

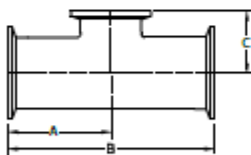

TUBE O.D.	A	B	C	316L PART NUMBER
1"	2.37	4.75	1.13	W67MPS-1
1-1/2"	2.75	5.50	1.38	W67MPS-15
2"	3.50	7.00	1.63	W67MPS-2
2-1/2"	3.50	7.00	1.88	W67MPS-25
3"	3.75	7.50	2.13	W67MPS-3
4"	4.50	9.00	2.75	W67MPS-4

## REDUCING SHORT OUTLET CLAMP TEES 7RMPS

**NEW!**

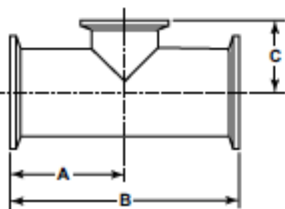

TUBE O.D.	A	B	C	316L PART NUMBER
1-1/2" X 1"	2.16	4.31	1.37	W67RMPS-15X1
2" X 1"	2.56	5.12	1.62	W67RMPS-2X1
2" X 1-1/2"	2.56	5.12	1.62	W67RMPS-2X15
2-1/2" X 2"	2.84	5.69	1.87	W67RMPS-25X2
3" X 1-1/2"	3.09	6.19	2.12	W67RMPS-3X15
3" X 2"	3.09	6.19	2.12	W67RMPS-3X2
4" X 2"	4.06	8.12	2.62	W67RMPS-4X2
4" X 3"	4.06	8.12	2.62	W67RMPS-4X3