

# CLAMP FERRULES

## AUTOMATIC WELD FERRULES TL14AM7

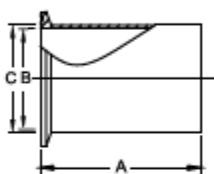

TUBE O.D.	A	B	C	316L PART NUMBER
1/2"	1.75	0.37	0.50	W6TL14AM7-.50
3/4"	1.75	0.62	0.75	W6TL14AM7-.75
1"	1.75	0.87	1.00	W6TL14AM7-1
1-1/2"	1.75	1.37	1.50	W6TL14AM7-15
2"	2.25	1.87	2.00	W6TL14AM7-2
2-1/2"	2.25	2.37	2.50	W6TL14AM7-25
3"	2.25	2.87	3.00	W6TL14AM7-3
4"	2.25	3.83	4.00	W6TL14AM7-4
6"	3.00	5.78	6.00	W6TL14AM7-6

• 3A Finish - 32R<sub>a</sub> ID/OD polish

## REDUCING FERRULES 31WMP

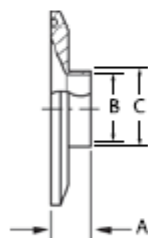

CLAMP END	TUBE O.D.	A	B	C	316L PART NUMBER
1-1/2"	1"	0.50	0.87	1.00	W631WMP-15X1
2"	1"	0.50	0.87	1.00	W631WMP-2X1
2"	1-1/2"	0.50	1.37	1.50	W631WMP-2X15
2-1/2"	1-1/2"	0.50	1.37	1.50	W631WMP-25X15
2-1/2"	2"	0.50	1.87	2.00	W631WMP-25X2
3"	1-1/2"	0.50	1.37	1.50	W631WMP-3X15
3"	2"	0.50	1.87	2.00	W631WMP-3X2
3"	2-1/2"	0.50	2.37	2.50	W631WMP-3X25
4"	2"	0.62	1.87	2.00	W631WMP-4X2
4"	2-1/2"	0.62	2.37	2.50	W631WMP-4X25
4"	3"	0.62	2.87	3.00	W631WMP-4X3

• Ferrules are tapered

## ROLL-ON FERRULES 14RMP

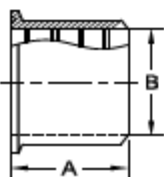

TUBE O.D.	A	B	304 PART NUMBER	316L PART NUMBER
1"	.75	1.01	W414RMP-1	W614RMP-1
1-1/2"	1.12	1.51	W414RMP-15	W614RMP-15
2"	1.31	2.01	W414RMP-2	W614RMP-2
2-1/2"	1.37	2.51	W414RMP-25	W614RMP-25
3"	1.44	3.01	W414RMP-3	W614RMP-3
4"	1.50	4.01	W414RMP-4	W614RMP-4
6"	2.00	6.01	W414RMP-6	W614RMP-6