

UNION HEX NUTS 13H

TUBE O.D.	A	B	304 PART NUMBER
1"	1.81	0.91	W413H-1
1-1/2"	2.41	0.97	W413H-15
2"	3.00	1.06	W413H-2
2-1/2"	3.59	1.19	W413H-25
3"	4.19	1.28	W413H-3
4"	5.42	1.50	W413H-4

• Hex Nut 400 PSI Maximum

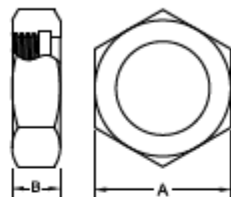

BEVEL SEAT FERRULES

SHORT PLAIN BEVEL SEAT WELD FERRULES 14PRF



TUBE O.D.	A	B	304 PART NUMBER	316L PART NUMBER
1"	0.72	0.87	W414PRF-1	W614PRF-1
1-1/2"	0.72	1.37	W414PRF-15	W614PRF-15
2"	0.75	1.87	W414PRF-2	W614PRF-2
2-1/2"	0.87	2.37	W414PRF-25	W614PRF-25
3"	0.91	2.87	W414PRF-3	W614PRF-3
4"	1.03	3.83	W414PRF-4	W614PRF-4

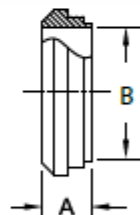

LONG PLAIN BEVEL SEAT FERRULES 14A



TUBE O.D.	A	B	304 PART NUMBER	316L PART NUMBER
1"	1.37	0.87	W414A-1	W614A-1
1-1/2"	1.50	1.37	W414A-15	W614A-15
2"	1.50	1.87	W414A-2	W614A-2
2-1/2"	1.75	2.37	W414A-25	W614A-25
3"	1.75	2.87	W414A-3	W614A-3
4"	1.75	3.83	W414A-4	W614A-4

